



EZ LATCH INSTALLATION

EZ LATCH INSTALLATION ONTO BUCKLEY FENCE

Leveling and aligning the gate must be done before mounting the EZ latch. Please refer to [page 17](#) for instructions on leveling the gate.

REQUIRED MATERIALS

1. $\frac{3}{8}$ " chuck drill motor
2. $\frac{1}{2}$ " Drill Bit *
3. Adjustable wrench
4. $\frac{5}{16}$ " Hex key wrench
5. Marking pen

PARTS PROVIDED (Figure 1)

- a. EZ Latch Kit which includes:
- b. Flanged support tube
- c. $\frac{3}{8}$ " latch pin
- d. Mounting plate
- e. Two $\frac{3}{8}$ " bolts
- f. Washers

*A step drill is preferred that starts small and steps up to $\frac{1}{2}$ ". If not available, we suggest multiple drills.

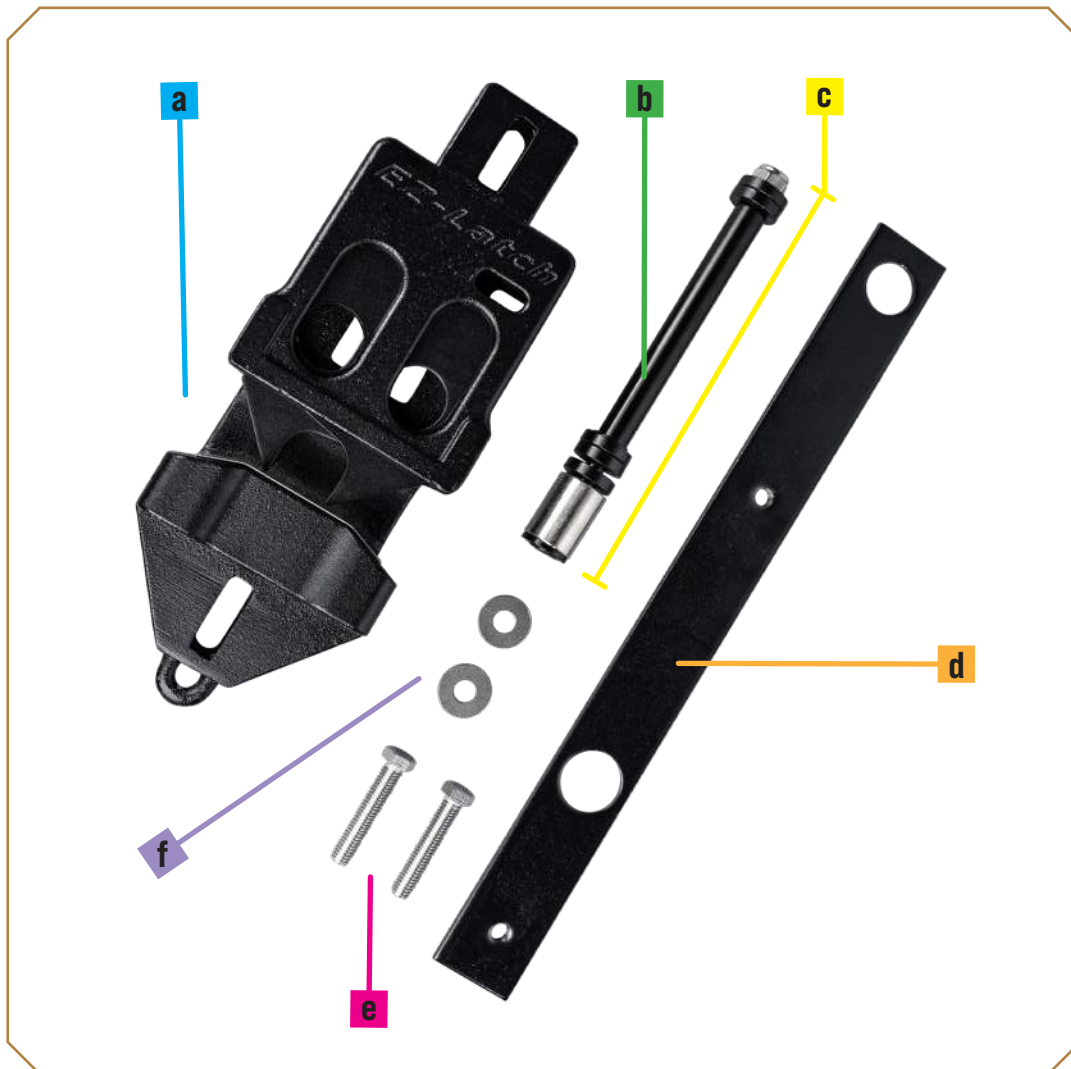

Figure 1

1 SETTING THE LATCH PIN

1. Place enough washers on the latch pin (Figure 1) to allow the end of the pin to clear the latch post by 1/2" or slightly more. Insert the 3/8" pin into the pre-drilled gate hole from the outside.
2. Slide the flanged support tube onto the pin from the inside of the gate around the latch pin (Figure 2).
3. Check the pin gap to the latch post. Adjust the washers to gap out between 1/2" and 3/4".
4. If the gap is too large, place the remaining washers and nut onto the pin (Figure 3).
5. Slide in the latch and move it up to make contact with the pin.
6. Tighten to 20 ft lbs of torque by using a 5/16" hex key in the end of the pin to hold it from rotation while tightening the nut.

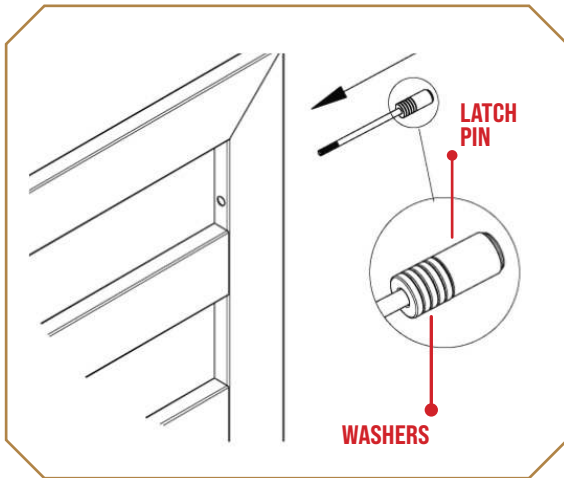

Figure 1

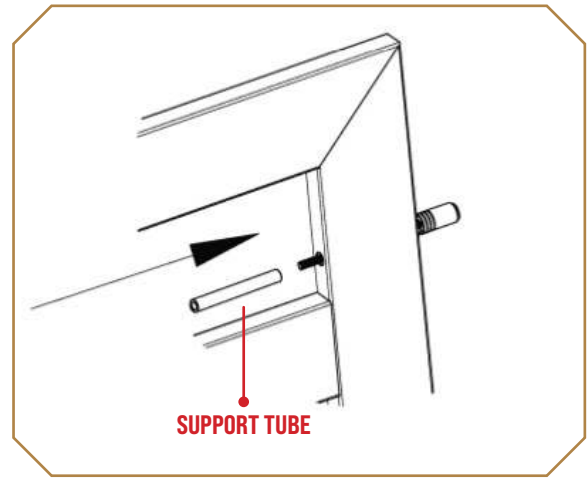

Figure 2

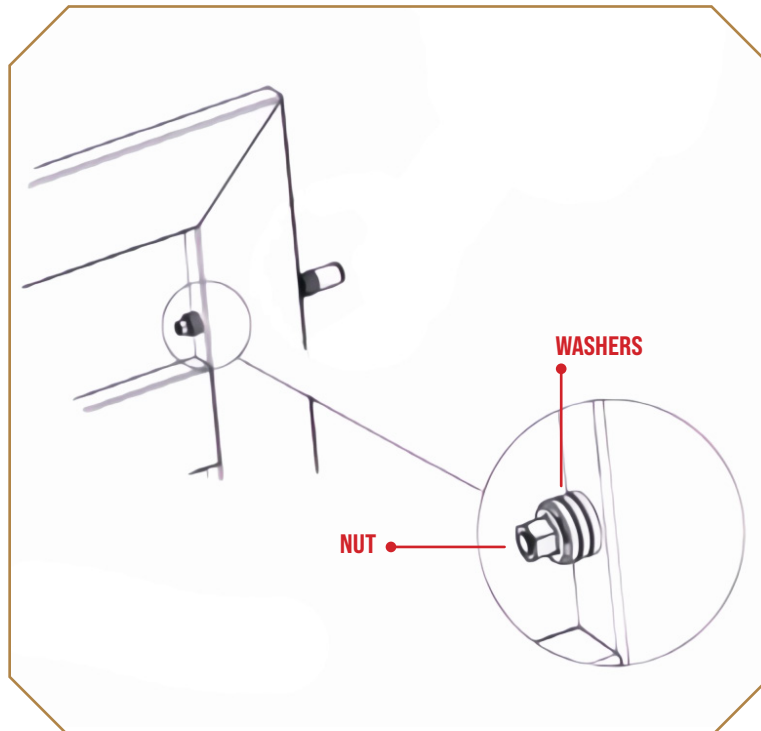

Figure 3

2 MOUNTING THE LATCH

1. Using the mounting plate, mark two hole centers that are 9 $\frac{3}{8}$ " apart. Assure they are centered on the inside of the latch post (Figure 5).
2. Drill two $\frac{1}{2}$ " diameter holes at the marked spots (preferably with a step drill).
3. Mount the top screw and washer through the latch by putting the screw through the drilled holes and then through the mounting plate, which is positioned on the inside of the post (Figure 6). As a safety measure, you may tie a string through the hole to allow retrieval of the plate should you accidentally drop it.
4. Finger tighten the latch to the post using the two screws and washers. With the screws snugged into position, swing the gate into the latch (Figure 4).
5. Push the latch upward to contact the latch pin and torque the mount screws to 20 ft lbs (Figure 7).
6. The bolt slots allow for $\frac{1}{2}$ " adjustment up and down. Adjust as required. Your latch is now secured.
7. Test your latch both ways. Be sure the pin slightly raises the gate when closing.

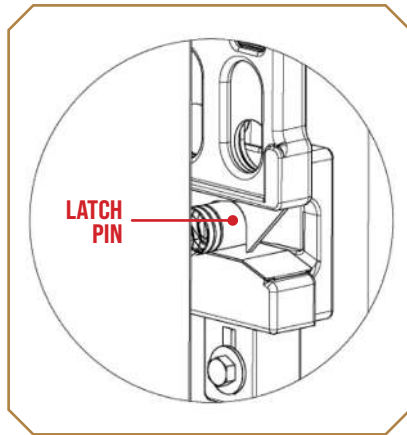

Figure 4

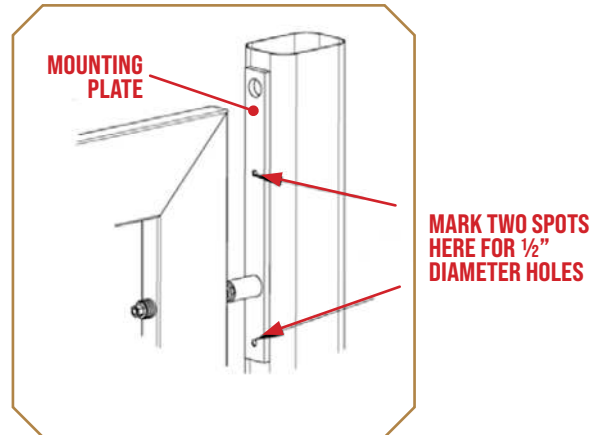

Figure 5

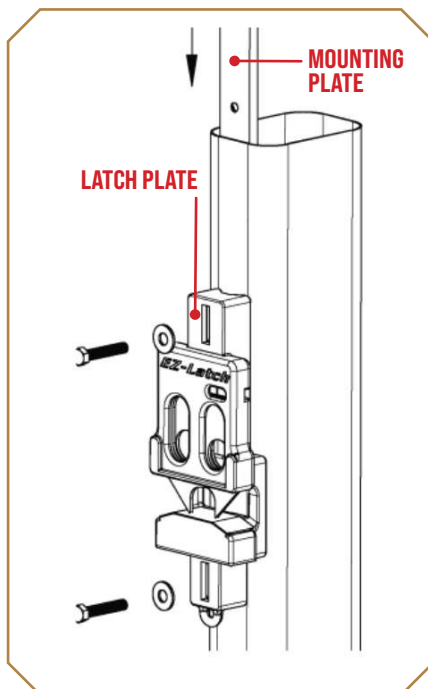

Figure 6

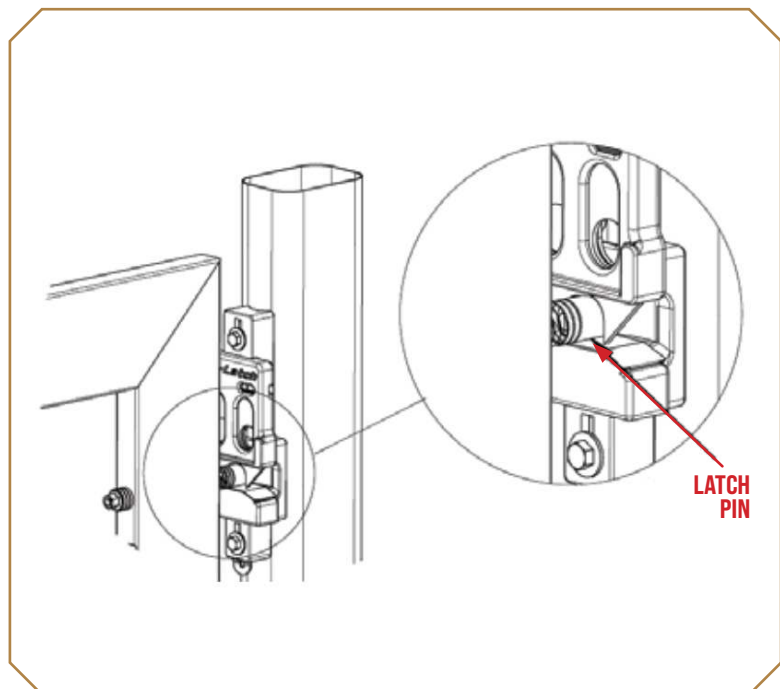

Figure 7